

304 Stainless Steel Cat-Back Exhaust Kit

2018-2023 Ford Mustang GT

(317660030, 317663030)

Installation Guide

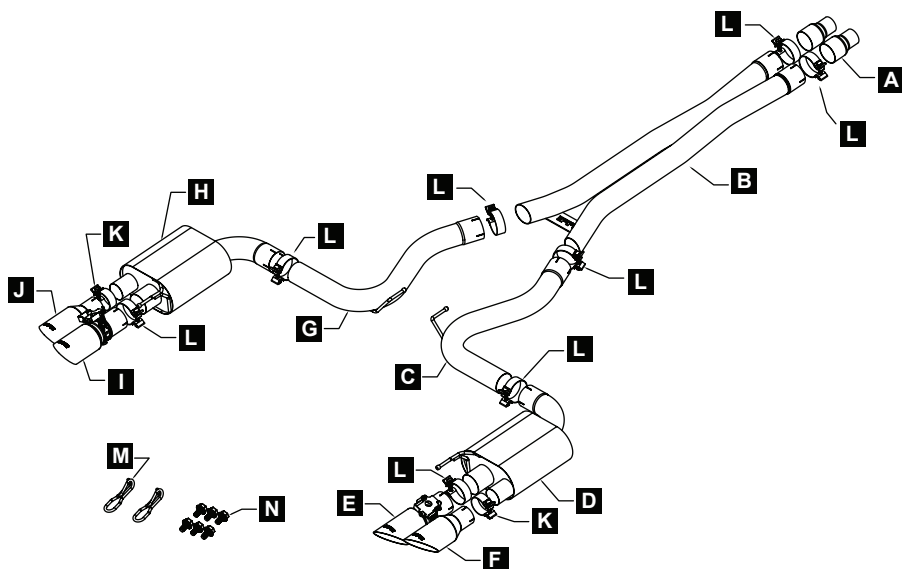

CONTENTS:

- | | |
|---------------------------------|-----------------------------------|
| A. (2) X-pipe adapter | H. (1) Driver-side muffler |
| B. (1) X-pipe | I. (1) Driver-side inner tip |
| C. (1) Passenger-side mid pipe | J. (1) Driver-side outer tip |
| D. (1) Passenger-side muffler | K. (2) Clamp flat strap 2.5" |
| E. (1) Passenger-side inner tip | L. (8) Clamp flat strap 3.0" |
| F. (1) Passenger-side outer tip | M. (2) Actuator valve spring |
| G. (1) Driver-side mid pipe | N. (6) Flange bolt M6-1.0 x 12mmL |

PREPARATION:

1. Read and understand these instructions before beginning.
2. Use penetrating lubricant on stock clamps, isolators, and hangers.
3. Vehicle off. Exhaust cool. Elevate and secure vehicle.

DISASSEMBLY:

1. Disconnect the left and right-side wire harnesses from the actuators. **(Fig. 1)** Slide the locking clip away from the actuator, then lift the tab while pulling the connector away. **(Fig. 2)**



2. Remove the harness from the support bracket attached to the actuator. This will fully disconnect the harness from the exhaust tip assembly.
3. Loosen the two clamps securing the cat-back to the manifold pipes using a 15mm deep socket. **(Fig. 3)**



4. Remove the two 13mm bolts securing the mid-hanger brackets, then unhook the brackets from their current position. (Fig. 4)

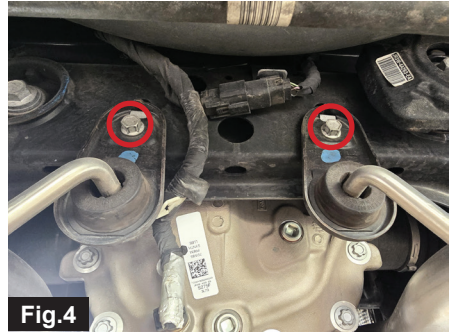

5. Slide the OEM exhaust assembly rearward until the stock resonator and sleeve clamps are free from the exhaust manifold pipes. Lower the front of the exhaust, then slide it forward to disengage the rear driver- and passenger-side hangers from the factory rubber isolators. Carefully remove the exhaust from the vehicle. Note: The OEM exhaust assembly weighs approximately 70 pounds, so assistance is recommended.

6. Remove the three 10mm nuts securing the actuators from each muffler assembly. Remove the small heat shield from each actuator and retain the wire harness support brackets as these will be reused. (Fig. 5)



INSTALLATION:

1. Reuse the two factory sleeve clamps, slide the X-pipe adapters **(A)** in place as shown. **(Fig. 6)**
2. Install the X-pipe **(B)** by sliding its inlets over the adapters **(A)** and loosely securing it with 3" clamps **(L)**, leaving room for adjustment. Next, place two additional 3" clamps **(L)** on the X-pipe outlets and install the driver-side mid-pipe **(G)** and passenger-side mid-pipe **(C)**. Finally, secure both mid-pipes using the factory mid-hanger brackets. **(Fig. 7)**
3. Install the passenger-side muffler **(D)** and driver-side muffler **(H)** by sliding them onto the mid-pipes using 3" clamps **(L)**. Then, insert the muffler hangers into the factory rubber insulators to secure them in place. Leave the clamps loose to allow for final adjustments.



4. Prepare passenger-side inner tip (**E**) and driver-side inner tip (**I**) by installing the actuator spring (**M**) onto the shaft of the valve in the orientation shown in (**Fig. 8**). Ensure the spring is fully seated and secured in the slot. (**Fig. 9**)

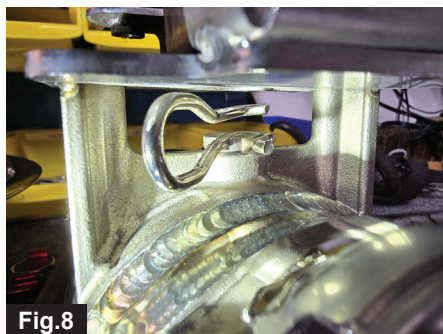

5. With the valve in the open position (**Fig. 10**), install the OEM actuator onto the PPE valve tip assembly, ensuring the harness slot is facing the tip's exit. Verify that the spring (**M**) is fully seated in the actuator's slot. (**Fig. 11**)

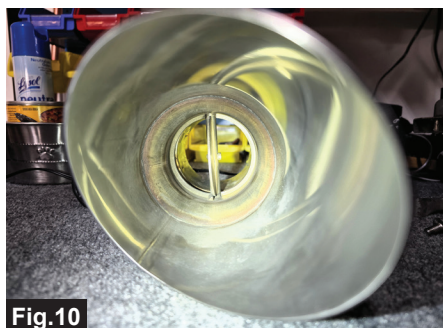

Performance Exhaust System

- Secure the actuator using the M6 flange bolts (**N**), then reinstall the factory harness support bracket in the innermost position as shown in (**Fig. 12**). Note: the driver-side tip is shown on the left, and the passenger-side tip is on the right.



Fig.12

- Install the driver-side inner tip (**I**) (**Fig. 13**), and passenger-side inner tip (**E**) (**Fig. 14**) onto the mufflers using 3" clamps (**L**). Leave the clamps loose to allow for final adjustment.

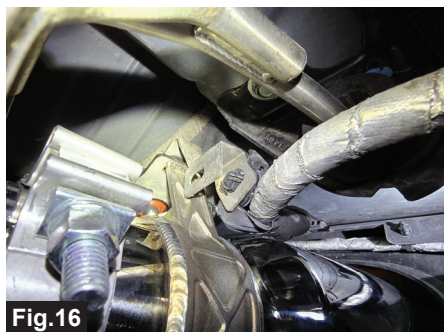

Fig.13



Fig.14

8. Reconnect the wiring harness to each actuator (**Fig. 15**), then secure the harness into the support bracket. (**Fig. 16**)



9. Install driver-side outer tip (**J**) and passenger-side outer tip (**F**) using 2.5" clamps (**K**). (**Fig. 17**)



10. Adjust the PPE exhaust system for proper fitment. Ensure the front X-pipe adapter overlaps the stock sleeve clamp, and adjust the rear muffler depth and rotation as needed. Align the exhaust tips so they are centered in the bumper valence, rotating them so the PPE logo is positioned on top. Verify that all hangers are properly seated in their corresponding grommets and check clearances between the exhaust system components and the chassis. Finally, start the vehicle and cycle through the exhaust modes from **Quiet** to **Track** to ensure proper operation.

Installation Complete

Page intentionally left blank.

DISCLAIMER OF LIABILITY

Performance products can increase horsepower above and beyond factory specifications. Additional horsepower creates more stress on the drive-train components, which could result in drive-train failure.

Note regarding emissions-related, non-E.O.-legal products: THESE PRODUCTS ARE LEGAL IN CALIFORNIA ONLY FOR RACING VEHICLES THAT MAY NEVER BE USED, OR REGISTERED OR LICENSED FOR HIGHWAY OR OFF-ROAD USE.

This agreement sets forth the terms and conditions for the use of PPE products. The installation of this product indicates that the Buyer has read and understands this agreement and accepts the terms and conditions. PPE (Pacific Performance Engineering) Inc., its distributors, employees, and dealers (the "Seller") shall not be responsible for the product's proper use and service. The buyer hereby waives all liability claims. The Buyer hereby acknowledges no reliance on the Seller's skill or judgment to select or furnish goods suitable for any particular purpose and that there are no liabilities which extend beyond the description on the face hereof, and the Buyer hereby waives all remedies or liabilities expressed or implied, arising by law or otherwise (including without any obligation of the Seller with respect to fitness, merchantability and consequential damages), or whether or not occasioned by the Seller's negligence. The Seller disclaims any warranty and expressly disclaims any liability for personal injury or damages. The Buyer acknowledges and agrees that the disclaimer of any liability for personal injury is a material term for this agreement and the Buyer agrees to indemnify the Seller and to hold the Seller harmless from any claim related to the item of equipment purchased. Under no circumstances will the Seller be liable for any damages or expenses by reason of use or sale of any such equipment. The Seller assumes no liability regarding the improper installation or misapplication of its products. It is the installer's responsibility to check for proper installation and if in doubt, contact the manufacturer. The Buyer is solely responsible for all warranty issues from the manufacturer.

LIMITATION OF WARRANTY

The Seller gives Limited Warranty as to description, quality, merchantability, and fitness for a particular purpose, productiveness, or any other matter of Seller's product sold herewith. The Seller shall not be responsible for the products proper use and service and the Buyer hereby waives all rights other than those expressly written herein. This warranty shall not be extended, altered or varied except by a written instrument signed by Seller and Buyer.

Limited lifetime warranty on all PPE cast aluminum products, and PPE Transmission Coolers. Three (3) year limited warranty on PPE Manifolds and Up-Pipes Kits, and OEM-Length Up-Pipes. One (1) year limited warranty on all other PPE products from the date of sale to original buyer and limited solely to the parts contained within the products kit. All products that are in question of Warranty must be returned prepaid to the Seller and must be accompanied by a dated proof of purchase receipt. All Warranty claims are subject to approval by Seller. Under no circumstances will the Seller be liable for any labor charged or travel time incurred in diagnosis for defects, removal, or re-installation - of this product or any other contingent expenses. Under no circumstances will the Seller be liable for any damage or expenses incurred by reason of the use or sale of any such equipment. In the event that the buyer does not agree with this agreement: the buyer may promptly return this product, in a new and unused condition in its original packaging, with a dated proof of purchase to the place of purchase within ten (10) days from date of purchase for a full refund. The installation of this product indicates that the buyer has read and understands this agreement and accepts its terms and conditions.



PACIFIC PERFORMANCE ENGINEERING

PPEpower.com